

PLAN OF SUBDIVISION		EDITION 1	PS 903086D	
LOCATION OF LAND PARISH: HUNTLY TOWNSHIP: — SECTION: 22 CROWN ALLOTMENT: 3 ^D (PART) & 5 (PART) CROWN PORTION: — TITLE REFERENCE: VOL. 12360 FOL. 208 LAST PLAN REFERENCE: PS 846156Y (LOT F7) POSTAL ADDRESS: WARATAH ROAD (at me of subdivision) HUNTLY, VIC, 3551 MGA CO-ORDINATES: E: 263 310 ZONE: 55 (of approx centre of land in plan) N: 5 939 185 GDA 2020		Council Name: Greater Bendigo City Council Council Reference Number: SC/903/2020/6 Planning Permit Reference: DS/903/2020 SPEAR Reference Number: S194738T Certification This plan is certified under section 11 (7) of the Subdivision Act 1988 Date of original certification under section 6 of the Subdivision Act 1988: 01/11/2022 Public Open Space A requirement for public open space under section 18 or 18A of the Subdivision Act 1988 has been made and the requirement has not been satisfied at Certification Digitally signed by: Liz Commadeur for Greater Bendigo City Council on 07/03/2023 Statement of Compliance issued: 14/06/2023 Public Open Space A requirement for public open space under section 18 or 18A of the Subdivision Act 1988 has been made and the requirement has been satisfied for: Later stage at Statement of Compliance		
VESTING OF ROADS AND/OR RESERVES		NOTATIONS		
IDENTIFIER	COUNCIL/BODY/PERSON			
ROAD R1, R2, R3 & R4	CITY OF GREATER BENDIGO			
NOTATIONS		LOT NUMBERS 1 TO 673 (INCLUSIVE) HAVE BEEN OMITTED FROM THIS PLAN. OTHER PURPOSES OF THIS PLAN <u>A.) CREATION OF RESTRICTIONS AS SHOWN ON SHEET 5.</u> THAT PART OF EASEMENT E-3 ON PS846156Y CONTAINED WITHIN R1 ON THIS PLAN IS EXTINGUISHED UPON THE REGISTRATION OF THIS PLAN UNDER THE PROVISIONS OF SCHEDULE 5 CLAUSE 14 OF THE ROAD MANAGEMENT ACT 2004.		
DEPTH LIMITATION: CROWN ALLOTMENT 3D - NIL CROWN ALLOTMENT 5 - 15.24m				
SURVEY: This plan is based on survey. (See PS828024U)				
STAGING: This is not a staged subdivision. Planning Permit No. DS/903/2020 This survey has been connected to permanent marks No(s). BAGSHOT 17 & 19. HUNTLY 15, 16, 26, 73, 76 & XHU16/1. In Proclaimed Survey Area No. ---				
EASEMENT INFORMATION				
LEGEND: A - Appurtenant Easement E - Encumbering Easement R - Encumbering Easement (Road)				
Easement Reference	Purpose	Width (Metres)	Origin	Land Benefited/In Favour Of
E-1	PIPELINES OR ANCILLARY PURPOSES	3	PS846156Y - SECTION 136 OF THE WATER ACT 1989	COLIBAN REGION WATER CORPORATION
E-1	DRAINAGE	3	PS846156Y	CITY OF GREATER BENDIGO
E-2	PIPELINES OR ANCILLARY PURPOSES	2.50	THIS PLAN - SECTION 136 OF THE WATER ACT 1989	COLIBAN REGION WATER CORPORATION
E-3	DRAINAGE	3	THIS PLAN	CITY OF GREATER BENDIGO
Beveridge Williams development & environment consultants Ballarat ph : 03 5327 2000 www.beveridgewilliams.com.au		SURVEYORS FILE REF: 1702011 - F7 1702011PS - STAGE F7.dwg Digitally signed by: Benjamin S. Long, Licensed Surveyor, Surveyor's Plan Version (06), 24/02/2023, SPEAR Ref: S194738T	ORIGINAL SHEET SIZE: A3 SHEET 1 OF 5 PLAN REGISTERED TIME: 7.41pm DATE: 27 / 6 / 2023 HEATH RICHARDS Assistant Registrar of Titles	

PS 903086D

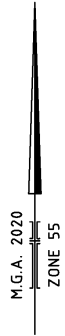
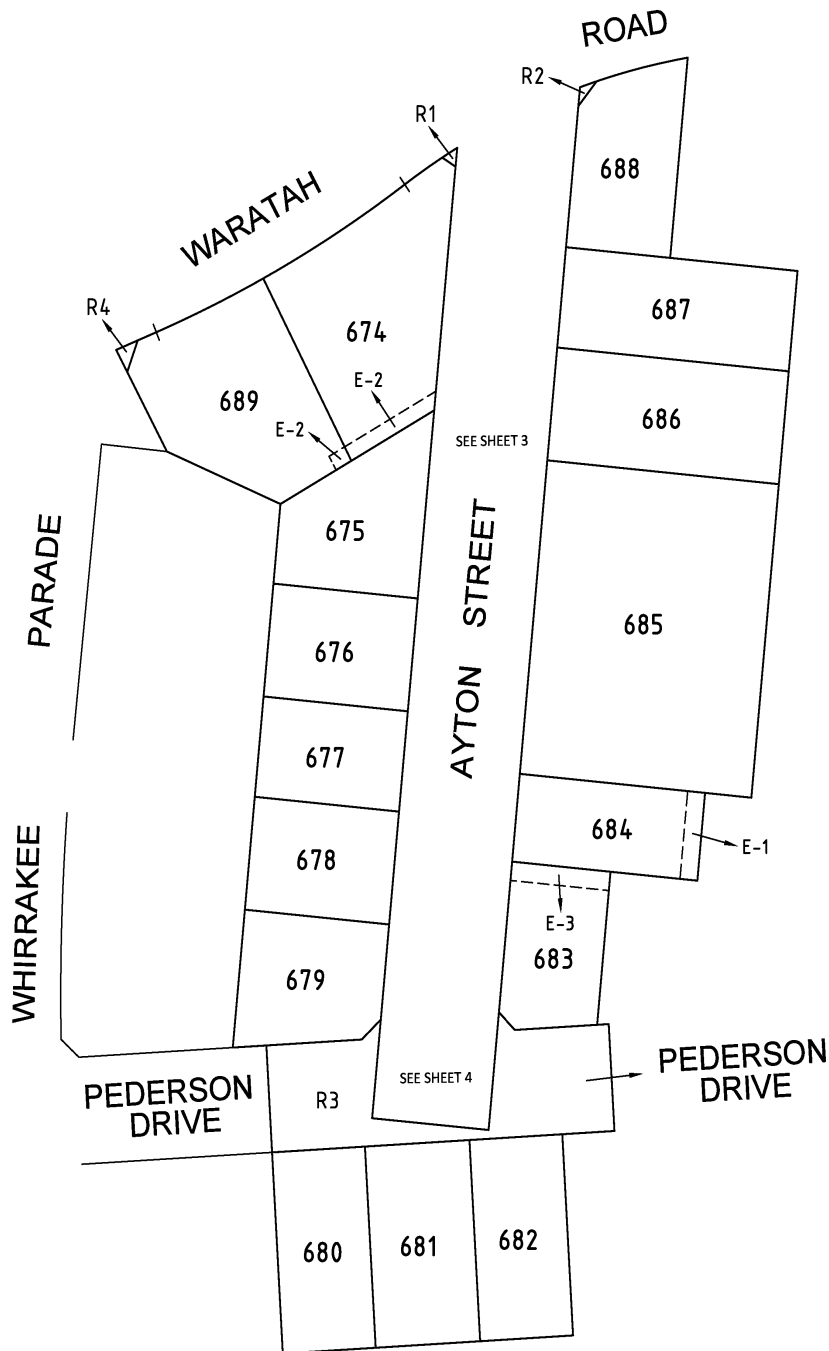

BW Beveridge Williams
 development & environment consultants
 Ballarat Ph: 03 5327 2000
www.beveridgewilliams.com.au

SURVEYORS REF
1702011 - F7

SCALE
1 : 750

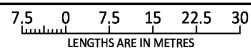

ORIGINAL SHEET
SIZE: A3

SHEET 2

Digitally signed by: Benjamin S. Long, Licensed Surveyor,
 Surveyor's Plan Version (06),
 24/02/2023, SPEAR Ref: S194738T

Digitally signed by:
 Greater Bendigo City Council,
 07/03/2023,
 SPEAR Ref: S194738T

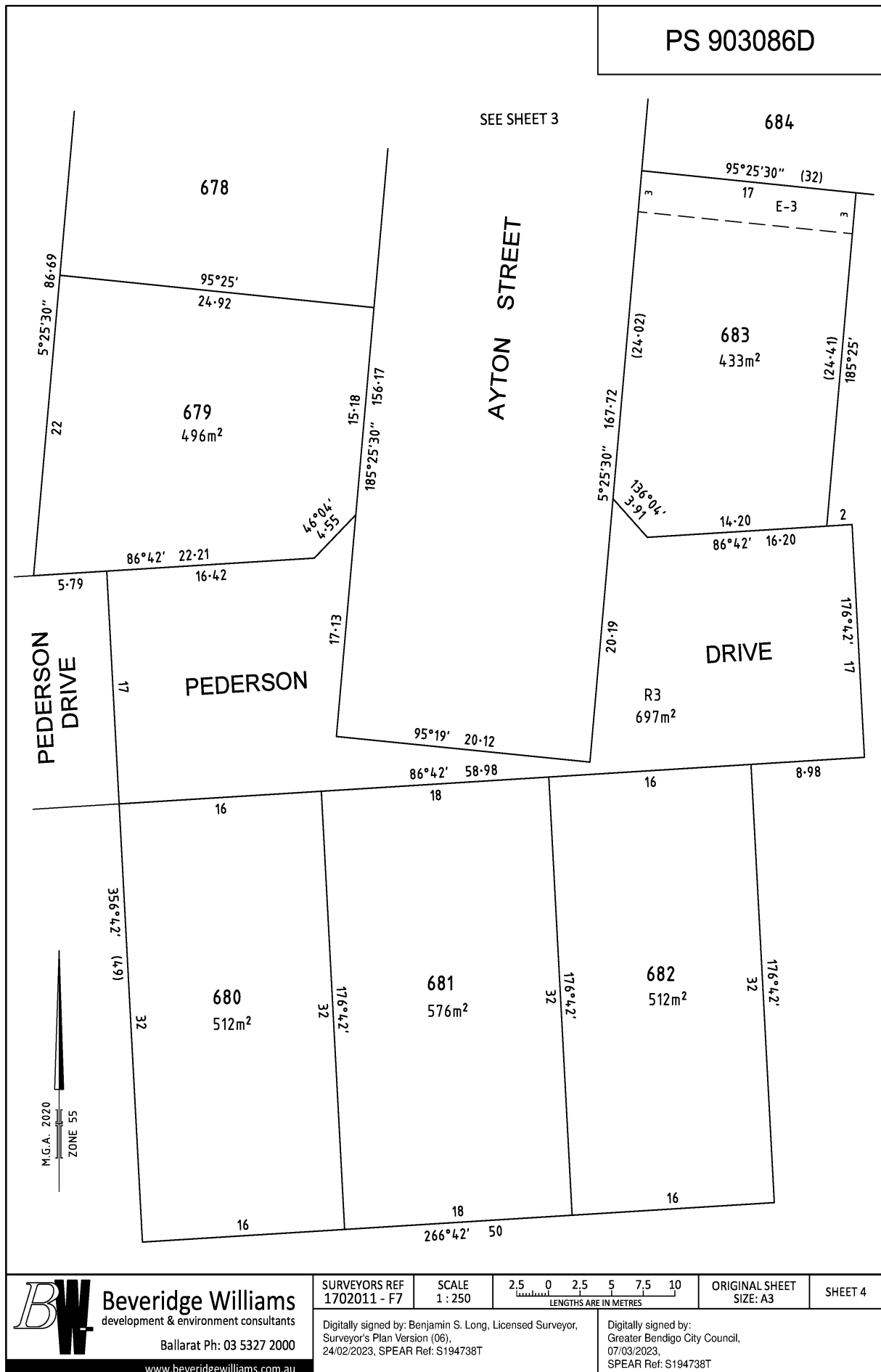

BW Beveridge Williams
 development & environment consultants
 Ballarat Ph: 03 5327 2000
www.beveridgewilliams.com.au

SURVEYORS REF 1702011 - F7	SCALE 1 : 250	<p>LENGTHS ARE IN METRES</p>	ORIGINAL SHEET SIZE: A3	SHEET 4
Digitally signed by: Benjamin S. Long, Licensed Surveyor, Surveyor's Plan Version (06), 24/02/2023, SPEAR Ref: S194738T		Digitally signed by: Greater Bendigo City Council, 07/03/2023, SPEAR Ref: S194738T		

